



## 47 Marston Lane

Anchorage Park, Portsmouth, PO3 5TW

Offers in the region of £450,000





# 47 Marston Lane

Anchorage Park, Portsmouth, PO3 5TW

Offers in the region of £450,000



## Welcome to Marston Lane...

Nestled in the highly sought-after and tranquil cul-de-sac of Marston Lane, Anchorage Park, this stunning four-bedroom detached property is now available on the sales market. Offering an immaculate finish throughout, this home is perfect for families seeking both space and modern living in a peaceful neighborhood.

The ground floor welcomes you with a contemporary and well-equipped kitchen/diner. This space features a range of stylish wall and base units, a convenient breakfast bar, and sleek spotlighting, creating an inviting setting for family meals or entertaining. Adjacent to the kitchen, a separate utility room provides practicality, housing laundry appliances and the central heating boiler, ensuring the main living areas remain clutter-free.

The spacious lounge, bathed in natural light, offers a comfortable retreat for relaxation and seamlessly connects to the conservatory. The conservatory opens to the beautifully maintained, private South-East facing garden—a serene outdoor space perfect for enjoying sunny afternoons or hosting gatherings. The garden also offers convenient side access to the garage, which is equipped with power, lighting, and an up-and-over door, adding flexibility and utility to the property. Completing the ground floor is a well-positioned WC, adding extra convenience for modern living.

Heading upstairs, the first floor continues to impress with four generously sized bedrooms. The master suite is a true highlight, featuring a contemporary en-suite bathroom, a walk-in wardrobe, and fitted

wardrobes, offering ample storage and a touch of luxury. Bedrooms two, three, and four also benefit from fitted wardrobes, providing practicality without compromising on style. The modern three-piece family bathroom, complete with high-quality fixtures, serves the additional bedrooms.

This home is presented in impeccable condition, with tasteful finishes and thoughtful design throughout. The combination of modern amenities, spacious interiors, and a well-maintained garden makes this property a standout choice for families or individuals looking to settle in a welcoming community.

Situated in Anchorage Park, the location is ideal for those seeking the perfect balance of tranquility and convenience. Local schools, parks, shops, and transport links are all within easy reach, making daily life seamless and enjoyable.

Don't miss the opportunity to make this beautiful house your home. Schedule a viewing today to experience everything this exceptional property has to offer.



Road Map



Hybrid Map



Terrain Map



Floor Plan

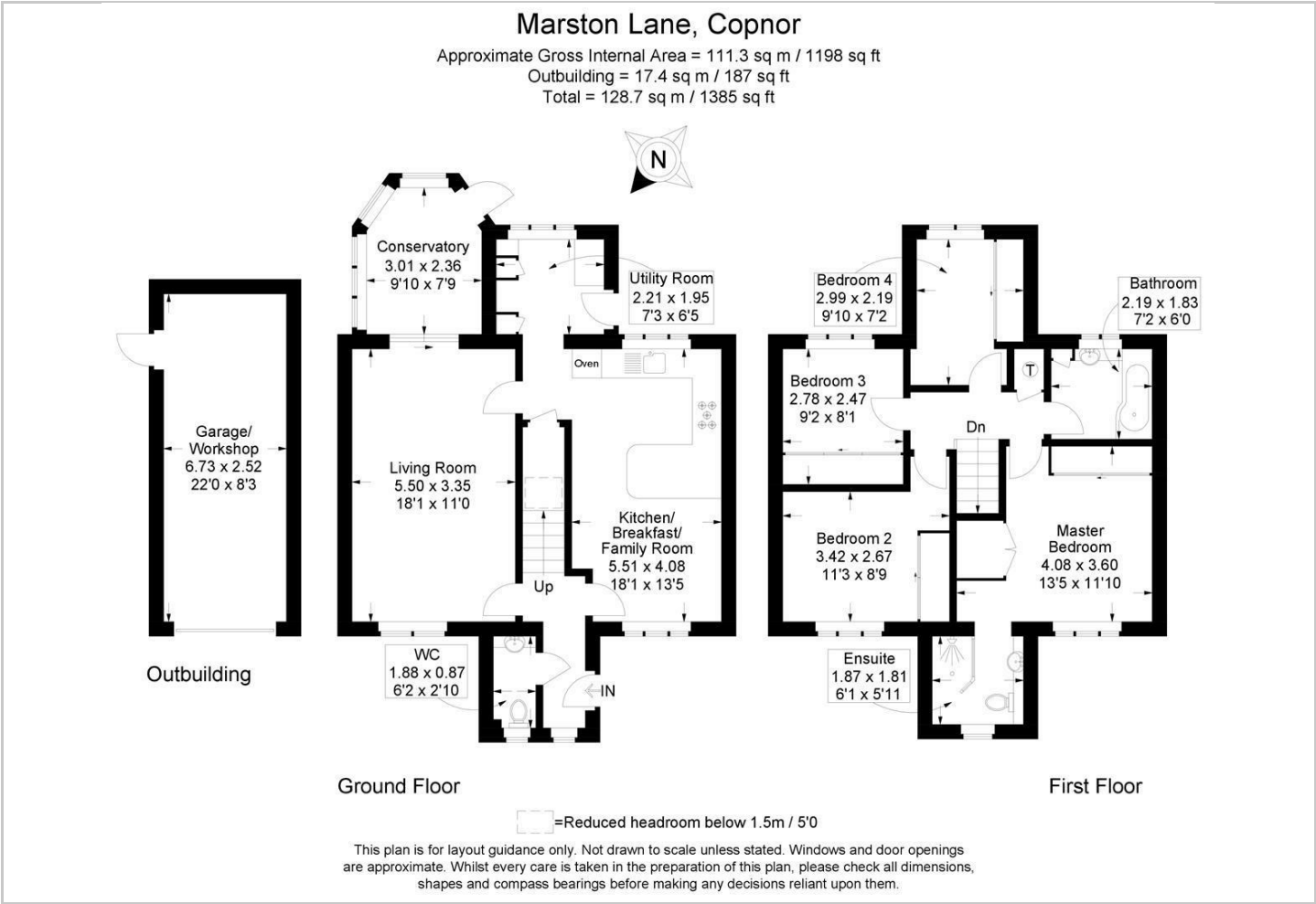

Viewing

Please contact our Central Office on 02394 217317 if you wish to arrange a viewing appointment for this property or require further information.

Energy Efficiency Graph



These particulars, whilst believed to be accurate are set out as a general outline only for guidance and do not constitute any part of an offer or contract. Intending purchasers should not rely on them as statements of representation of fact, but must satisfy themselves by inspection or otherwise as to their accuracy. No person in this firms employment has the authority to make or give any representation or warranty in respect of the property.